

PLUS-LIGHT™

Commercial Glueboard Insect Control

Please read these instructions carefully and store in a safe place for future reference.

PLUSLIGHT™

As part of the **Insect-O-Cutor®** brand of insect control products, **PlusLight™** is an effective and easily serviceable commercial flykiller which utilises highly effective UV tubes and is designed for use with a high specification glupac® glueboard. Two sizes of unit are available, **PlusLight™ 30** which can be desk or wall mounted and **PlusLight™ 60** which can be ceiling suspended.

CONTENTS OF PACKAGE

- 1 x PlusLight™ flykiller
- 1 x glupac® pheromone impregnated glueboard
- 2 x Screws and wall plugs (PlusLight™ 30 Only)
- 2 x Suspension keyrings and chain (PlusLight™ 60 Only)
- 1 x Mains cable (Type X)
- 2 x High powered UV tubes (Fitted)
or
- 4 x High powered UV tubes (Fitted)

WARNING - THIS APPLIANCE MUST BE EARTHED (CLASS 1)

INSECT CONTROL PRODUCTS

PlusLight™ utilises high powered ultra violet tubes to attract flying insects and retains the caught insects on a pheromone impregnated glueboard for inspection or hygienic disposal.

WARNING

PlusLight™ is not to be used by children or persons with reduced physical, sensory or mental capabilities, or lack of experience and knowledge, unless they have been given supervision or instruction.

Children should be supervised to ensure they do not play with the appliance.

If the mains cable is damaged it must be replaced by a specialist mains cable available from Pelsis Ltd or your supplier.

Not suitable for applications where potentially explosive environments may exist.

POSITIONING AND GUIDANCE FOR USING PLUSLIGHT™

THIS UNIT IS FOR INDOOR USE ONLY. NOT SUITABLE FOR USE IN BARNs, STABLES & SIMILAR LOCATIONS.

PlusLight™ should ideally be fixed around two meters above the ground, preferably in the darkest place within the area to be protected and is supplied with a two meter mains lead. Do not position the unit close to windows, skylights or other sources of light, or where it may be obscured by furniture, doors or other obstacles. Ideally, **PlusLight™** units should be visible from every part of the area to be protected.

PlusLight™ should ideally be in operation for 24 hours a day, ensuring your premises are kept free of flying insects. Insects are most attracted to **PlusLight™** at night when there is no competition from daylight or other light sources.

INSTALLATION

INSTALLATION SHOULD BE CARRIED OUT BY SERVICE PERSONNEL ONLY.

PlusLight™ should be mounted as shown in the mounting options section of this document. Keep out of the reach of children. Once installed in position, fit the glupac® glueboard in position as described in the glueboard replacement section of this document. Use the removable mains lead and plug to connect the **PlusLight™** to an appropriate power supply.

CLEANING

CLEANING SHOULD BE CARRIED OUT BY SERVICE PERSONNEL ONLY, AFTER ENSURING THAT THE UNIT IS DISCONNECTED FROM THE MAINS SUPPLY.

It is recommended that cleaning is carried out regularly when the glueboard is replaced. Once the glueboard is removed, the unit should be thoroughly wiped down with a damp cloth, removing any build up of dirt. Ensure the unit is completely dry before reconnecting it to the power supply.

GUARANTEE

PlusLight™ has a two year guarantee and if maintained as recommended in these instructions should continue to work for many years.* Use of non-approved consumables may invalidate the guarantee. Ensure genuine glupac® glueboards are used in conjunction with this product.

*Excludes tubes, glueboards and starters. Does not cover breakdown due to misuse, incorrect operation or use in an incorrect application.

MOUNTING FIXING CENTRES

Method	PL30	PL60
Wall	300mm	-
Suspended	-	470mm

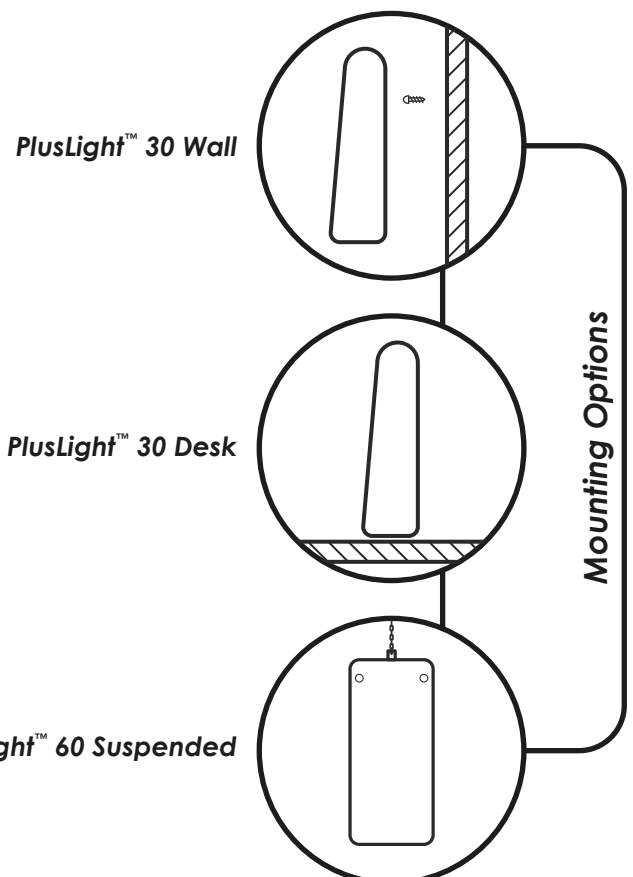

PL30 & PL60

GLUEBOARD REPLACEMENT

GLUEBOARD REPLACEMENT SHOULD BE CARRIED OUT BY SERVICE PERSONNEL ONLY, AFTER ENSURING THAT THE UNIT IS DISCONNECTED FROM THE MAINS SUPPLY.

The glueboard should be replaced every month with a genuine glupac® glueboard. Use of non-approved glueboards may invalidate your guarantee. **PlusLight™** comes supplied with discreet black glueboards with printed grids for simple insect evaluation and monitoring.

To replace the glueboard...

PlusLight™ 30

1. Remove the mains cable from your **PlusLight™**.
2. Swing open the front guard until it rests open against the fixing surface.
3. Remove the used glupac® glueboard by simply releasing from the metal chassis and either retain for catch evaluation or dispose of it hygienically.
4. Remove the protective release paper from the new glupac® glueboard.
5. Carefully position the new glupac® glueboard into position with the adhesive side facing the tubes, ensuring the glueboard is held in position by the metal clips at the top of the metal chassis.

PlusLight™ 60

1. Swing open the front guard until it is held in position by the aluminium clips.
2. Remove the used glupac® glueboard by simply releasing from the metal chassis and either retain for catch evaluation or dispose of it hygienically.
3. Remove the protective release paper from the new glupac® glueboard.
4. Carefully position the new glupac® glueboard into position with the adhesive side facing the tubes, ensuring the glueboard is held in position by the metal clips at the top of the metal chassis.
5. Release the front guard by pulling the aluminium clips away from the chassis.

Always ensure the selected genuine glupac® glueboards are compatible with your unit, available from your PCO or Pelsis Ltd.

TUBE REPLACEMENT

TUBE REPLACEMENT SHOULD BE CARRIED OUT BY SERVICE PERSONNEL ONLY, AFTER ENSURING THAT THE UNIT IS DISCONNECTED FROM THE MAINS SUPPLY.

To ensure the efficiency of **PlusLight™** in catching flying insects, the UV tubes should be replaced annually. After twelve months the phosphor coating that emits the correct wavelength of UV light has burnt away and the UV output is diminished substantially.

To replace the UV tubes...

1. Rotate the tube through 90°, freeing it from the tube holders.
2. Pull the tube away from the chassis.
3. Dispose of the used UV tube in conjunction with local WEEE regulations.

STARTER REPLACEMENT

STARTER REPLACEMENT SHOULD BE CARRIED OUT BY SERVICE PERSONNEL ONLY, AFTER ENSURING THAT THE UNIT IS DISCONNECTED FROM THE MAINS SUPPLY.

The starters provide an extra spark to initially light the UV tube. Starters wear out and should be replaced at the same intervals as the UV tubes.

To replace the starters...

1. Rotate the starter anti-clockwise.
2. Pull the starter free from the unit.

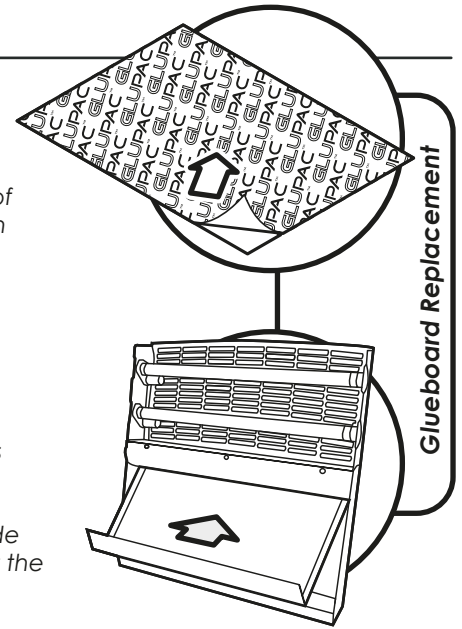

Glueboard Replacement

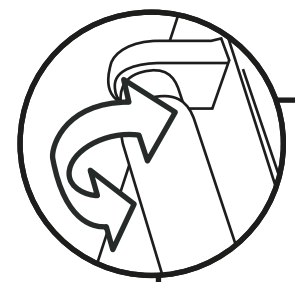

Tube Replacement

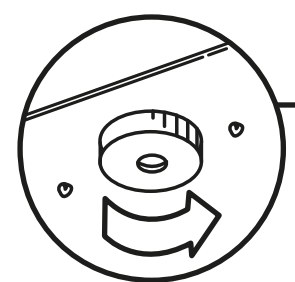
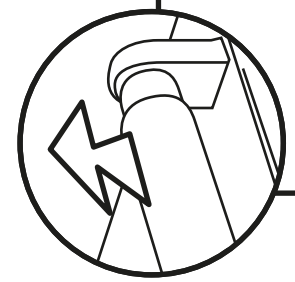

Starter Replacement

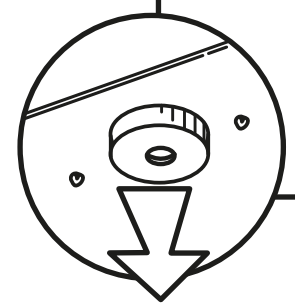

SPECIFICATION / REPLACEMENT PARTS

Unit	PL30 White	Unit	PL60 S/S
Voltage	220V ~ 60Hz	Voltage	220V ~ 60Hz
Dimensions(mm)	470 x 285 x 90	Dimensions(mm)	470 x 330 x 130
Coverage	80 Sq. Meters	Coverage	160 Sq. Meters
Weight	4 Kg	Weight	7 Kg
Light Output	30W	Light Output	60W
Tubes	2 x TP15-18	Tubes	4 x TP15-18
Starter	2 x I154	Starter	4 x I154
Glueboards (x6)	INF309	Glueboards (x6)	INF309