

INSECT-O-CUTOR®

Professional Electric Insect Control

Please read these instructions carefully and store in a safe place for future reference.

Select

As part of the **Insect-O-Cutor®** brand of insect control products, the **Select** range is an effective and flexible range of professional flykillers which utilise highly effective **Synergetic®** UV tubes. Constructed from coated mild steel or robust stainless steel, the **Select** range can be wall mounted or ceiling suspended.

- Contents of package
- 1 x Insect-O-Cutor flykiller
 - 1 x Mains cable (Type X)
 - 2 x Wall mounting screws and wall plugs
 - 2 x Suspension hooks
 - 1 x Backplate
 - 1 x High powered UV tube (SE22 - Fitted)
- or
- 2 x High powered UV tubes (SE44 - Fitted)

WARNING - THIS APPLIANCE MUST BE EARTHED (CLASS 1)

INSECT CONTROL PRODUCTS

The **Select** range utilise high powered ultra violet tubes to attract flying insects and then electrocutes them on a killing grid, before collecting them in a removable catch tray.

WARNING

The **Select** range is not to be used by persons with reduced physical, sensory or mental capabilities, or lack of experience and training, unless they have been given instruction.

Children should be supervised to ensure they do not play with the appliance.

If the mains cable is damaged it must be replaced by a specialist mains cable available from Pelsis Ltd or your supplier.

The **Select** range must only be used in areas which are free of dust and any possible explosive vapour mixture, are suitable for indoor use only and are not suitable for use in barns, stables and similar locations.

POSITIONING AND GUIDANCE FOR USE

The **Select** range should ideally be fixed around two meters above the ground, preferably in the darkest place within the area to be protected. Do not position the unit close to windows, skylights or other sources of light, or where it may be obscured by furniture, doors or other obstacles.

The **Select** range should ideally be in operation for 24 hours a day, ensuring your premises are kept free of flying insects. Insects are most attracted to the **Select** range units at night when there is no competition from daylight or other light sources.

GUARANTEE

The **Select** range has a five year guarantee and if maintained as recommended in these instructions should continue to work for many years*. Use of non-approved consumables may invalidate the guarantee.

INSTALLATION

INSTALLATION SHOULD BE CARRIED OUT BY SERVICE PERSONNEL ONLY.

Before installation, first remove the plastic tie-wraps that are securing the removable killing grid in place during transit. The **Select** range should be mounted as shown in the mounting options section of this document. Keep out of reach of children.

Wall Mounting - Install the supplied wall plugs and screws to the mounting surface, having first made sure that appropriate wall plugs are used for specialist mounting materials, such as plasterboard.

Over time, Ultraviolet light may discolour the mounting surface. If this would be a problem, mount the supplied backplate between the back of the flykiller and the wall.

Ceiling Suspension - Fit the suspension hooks to the top of the unit, by first removing the two top screws, then replacing them with the suspension hooks in place. Then fix the suspension chains to the hooks. The **Select** range should be hung 2 - 3m from the ground, please ensure chains of appropriate length and strength are sourced.

Once installed into position, use the removable mains lead and plug to connect the **Select** range to an appropriate power supply, as specified on the specification label found on the flykiller.

CLEANING

CLEANING SHOULD BE CARRIED OUT BY SERVICE PERSONNEL ONLY, AFTER ENSURING THAT THE UNIT IS DISCONNECTED FROM THE MAINS SUPPLY.

It is recommended that cleaning is carried out regularly every month. During cleaning the unit should be thoroughly wiped down with a damp cloth, removing any build up of dirt.

Ensure the unit is completely dry before reconnecting it to the power supply.

MOUNTING FIXING CENTRES

METHOD	SE22	SE44
Wall	150mm	365mm
Suspended	300mm	511mm

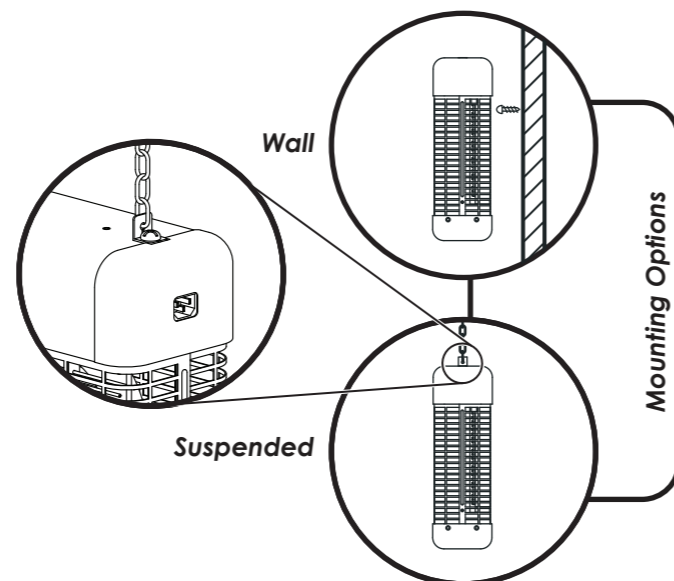

*Excludes tubes and starters. Does not cover breakdown due to misuse, incorrect operation or use in an incorrect application.

Select

Select

INSECT-O-CUTOR®

CATCH TRAY AND FRONT GUARD REMOVAL

To remove the front guard, the catch tray must first be removed as shown to the right. The front guard is connected to the power supply of the unit via a hidden switch. By removing the front guard the connection is broken and power is cut to the unit. This ensures safe access to the unit for servicing and cleaning.

NB - WHEN REPLACING THE FRONT GUARD BACK INTO THE SELECT RANGE, ENSURE IT IS PUSHED FULLY INTO POSITION AND THAT POWER IS RESTORED TO THE UNIT.

NB - THE FRONT GUARD CAN ONLY BE RELEASED ONCE THE CATCH TRAY IS REMOVED

TUBE REPLACEMENT

TUBE REPLACEMENT SHOULD BE CARRIED OUT BY SERVICE PERSONNEL ONLY, AFTER ENSURING THAT THE UNIT IS DISCONNECTED FROM THE MAINS SUPPLY.

To ensure the efficiency of the **Select** range in catching flying insects, the UV tube(s) should be replaced annually. After twelve months the phosphor coating that emits the correct wavelength of UV light has burnt away and the UV output is diminished substantially.

To replace the UV tube(s)...

1. Remove the catch tray.
2. Remove the front guard.
3. Pull the tube away from the tube holder.
2. Pull the tube away from the tube clip.
3. Dispose of the used UV tube in conjunction with local WEEE regulations.

STARTER REPLACEMENT

STARTER REPLACEMENT SHOULD BE CARRIED OUT BY SERVICE PERSONNEL ONLY, AFTER ENSURING THAT THE UNIT IS DISCONNECTED FROM THE MAINS SUPPLY.

The starters provide an extra spark to initially light the UV tubes. Starters wear out and should be replaced at the same intervals as the UV tubes.

To replace the starter(s)...

1. Remove the catch tray.
2. Remove the front guard.
3. Rotate the starter anti-clockwise.
4. Pull the starter free from the unit.

KILLING GRID REMOVAL

REMOVAL OF THE KILLING GRID SHOULD BE CARRIED OUT BY SERVICE PERSONNEL ONLY, AFTER ENSURING THAT THE UNIT IS DISCONNECTED FROM THE MAINS SUPPLY.

To help with servicing and cleaning, the killing grid within the **Select** range can be removed.

To remove the killing grid...

1. Remove the catch tray.
2. Remove the front guard.
3. Remove the tube(s).
4. Pull the killing grid forward, to release it from the plastic clips.
5. Pull the killing grid down to free it from the unit.

SPECIFICATION / REPLACEMENT PARTS

Unit	SE22 (White) / SE23 (S/S)	Unit	SE44 (White) / SE45 (S/S)
Voltage	230V ~ 50Hz	Voltage	230V ~ 50Hz
Dimensions(mm)	376 x 140 x 420	Dimensions(mm)	592 x 140 x 420
Coverage	80 Sq. Meters	Coverage	160 Sq. Meters
Weight	5.6 Kg	Weight	7.2 Kg
Light Output	22W	Light Output	44W
Tubes	1 x TGX22	Tubes	2 x TGX22
Starter	1 x I154	Starter	2 x I154

DANGEROUS VOLTAGE

R4 190318

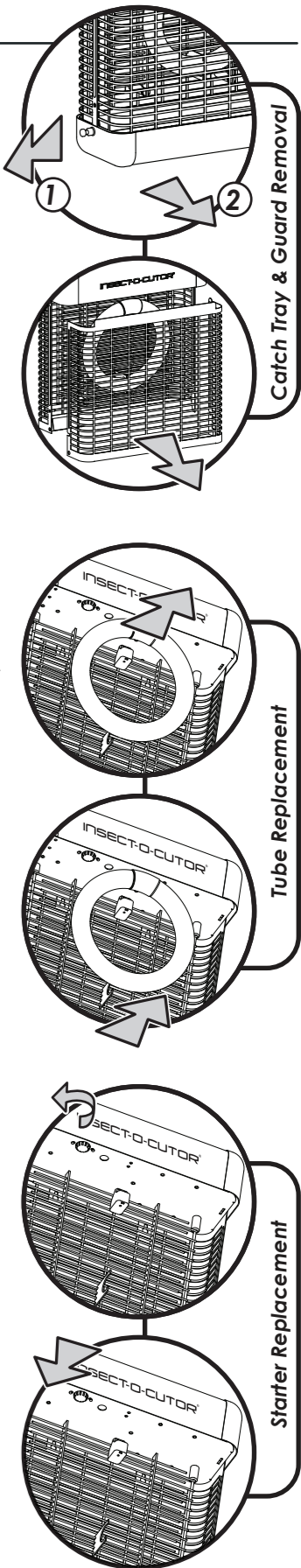

Sterling House
Grimbald Crag Close
Knaresborough
North Yorkshire
HG5 8PJ UK

T +44 (0)800 988 5359
F +44 (0)1423 863 497
W www.pelsis.com
E info@pelsis.com



Information provided on these instructions is modified and updated from time to time. This is due to the constant redevelopment of our products. As such, it is not intended that you should rely on it or that it should form part of any contract.

Pelsis Ltd

© 2018